

T17 Series

Shape BCM/CM

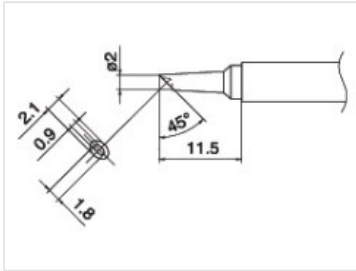

T17-BCM2 Shape-2BC with indent

B2706 Nozzle assembly A

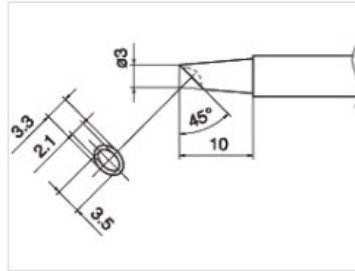

T17-BCM3 Shape-3BC with indent

B2900 Nozzle assembly G

Shape BC/C

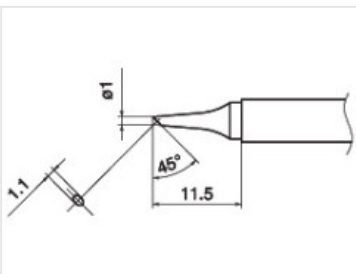

T17-BC1 Shape-1BC

B2899 Nozzle assembly F

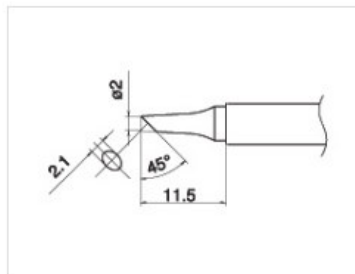

T17-BC2 Shape-2BC

B2706 Nozzle assembly A

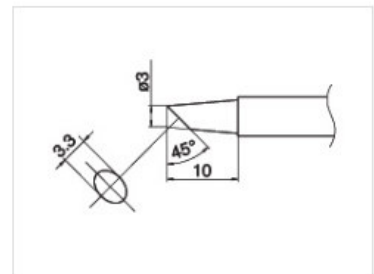

T17-BC3 Shape-3BC

B2900 Nozzle assembly G

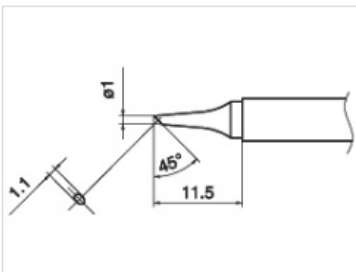

T17-BCF1 Shape-1BC

Tinned cut surface only

B2899 Nozzle assembly F

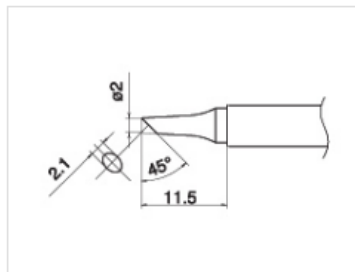

T17-BCF2 Shape-2BC

Tinned cut surface only

B2706 Nozzle assembly A

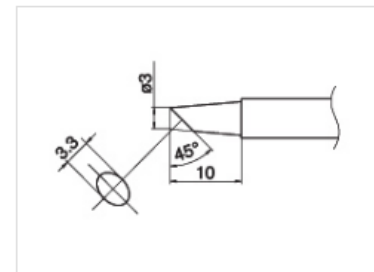

T17-BCF3 Shape-3BC

Tinned cut surface only

B2900 Nozzle assembly G

Shape B

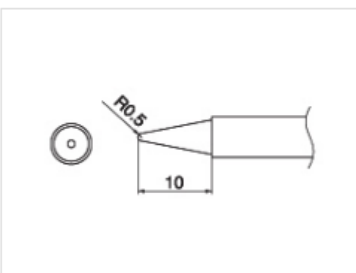

T17-B2 Shape-0.5B

B2708 Nozzle assembly C

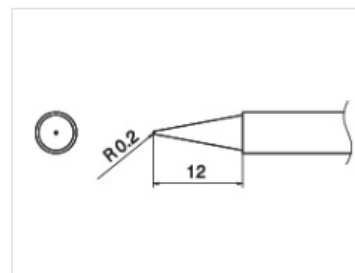

T17-BL Shape-BL

B2898 Nozzle assembly E

Shape D

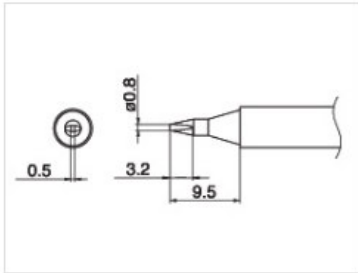

T17-D08 Shape-0.8D

B2709 Nozzle assembly D

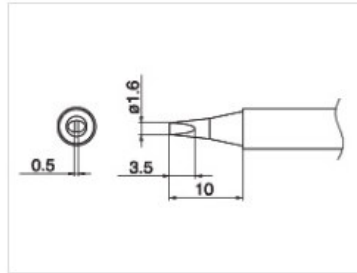

T17-D16 Shape-1.6D

B2708 Nozzle assembly C

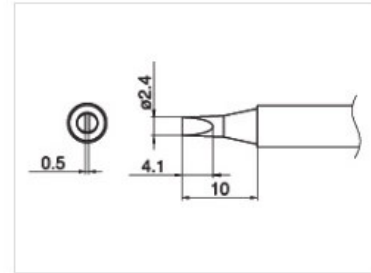

T17-D24 Shape-2.4D

B2708 Nozzle assembly C

Shape J

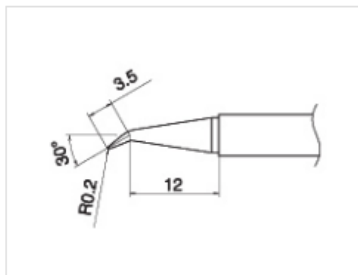

T17-J02 Shape-0.2J

B2707 Nozzle assembly B

Shape K

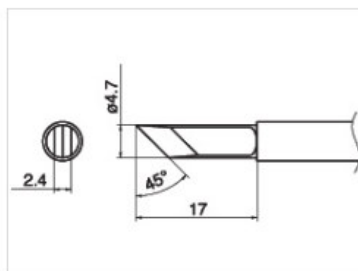

T17-KF Shape-KF

B2923 Nozzle assembly J

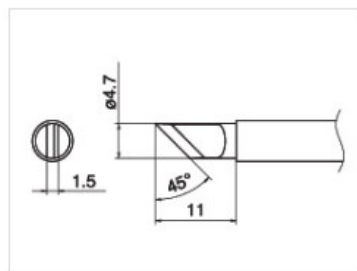

T17-KR Shape-KR

B2902 Nozzle assembly I

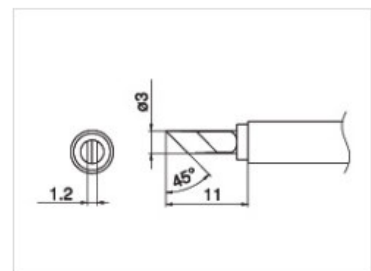

T17-KU Shape-KU

B2901 Nozzle assembly H